

Universal Manifold II

UNIVERSAL MANIFOLD AND CONTROLLER



The Universal Manifold II and Manifold Controller collect data from up to 32 locations via multiplexed monitoring. The manifold design allows shorter purge times, increasing the number of samples per day. Users view data, configure, and control the system on the Manifold Controller, which can be placed at a convenient location up to 4,000 feet from the Universal Manifold II.

The Universal Manifold II and Manifold Controller interface with Lighthouse particle counters and existing building automation and facility management systems, providing the lowest cost per point on the market.

FEATURES

- Multiplexed monitoring up to 32 locations
- Localized control
- Local display of current and historical data
- Faster purge times equals more samples per day
- Low flow alarm
- 2 Year Warranty

32 PORT MANIFOLD

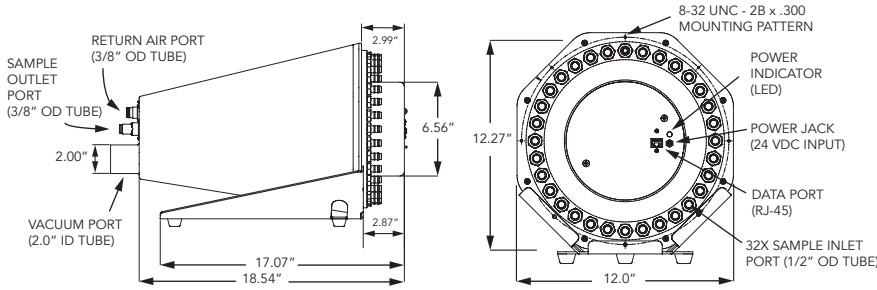

MANIFOLD CONTROLLER

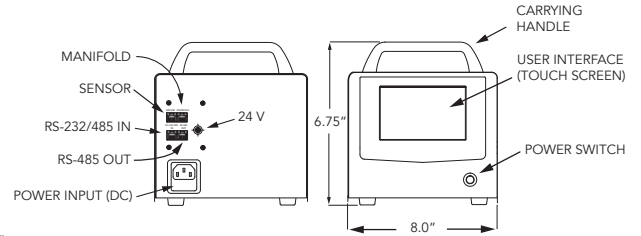

TECHNICAL DATASHEET

Universal Manifold and Controller

Specifications

Sample Ports	32
Flow Rate	3 CFM (84.9 LPM) per port (nominal)
Cross-Port Contamination	< 0.01%
Particle Sample Tubing	Particle transport tubing 1/2" OD, 3/8" ID (1.25 cm OD, 0.94 cm ID)
Sample Tubing Length	Up to 115 feet (35 m) per port
Fittings Provided	32 barbed port fittings, 1/2" (1.25 cm) OD tubing connection
Power	24 VDC
Dimensions	21.6"(l) x 12.0"(w) x 12.75"(h), [54.86(l) x 30.48(w) x 32.38(h) cm]
Weight	16 lbs 6 oz, (7.43 kg)

Manifold Controller

Compatible Software	LMS Express RT; LMS Pharma, LMS Pro and most factory automation systems
Communication Protocol	RS-485 / Modbus
Dimensions	5.75"(l) x 8.0"(w) x 6.75" h, [14.61(l) x 20.32(w) x 17.15(h)]
Weight	4.0 lbs 6 oz, (1.98 kg)

Optional Manifold Blower

Safety Provision	Automatic pump shut-off
Power	208, 415 VAC - Three Phase
Dimensions	16.7"(l) x 15.0"(w) x 20"(h), [42.42(l) x 38.1(w) x 50.8(h) cm]
Weight	75 lbs, (34 kg)

Environmental Conditions

Operating	50°F to 104°F (10°C to 40°C) / 20% to 95% non-condensing
Storage	14°F to 122°F (-10°C to 50°C) / Up to 98% non-condensing

Optional Printed operating manual; manifold vacuum blower, isokinetic sample probes; sample tubing; data cable, air flow balancing unit; 2 Inch reinforced vacuum tubing.

Distributed By:



Lighthouse Worldwide Solutions reserves the right to change specifications without notice.